

# 90° Gas Ball Valves



## MATERIALS

Body: Brass CW617N-UNIEN12165  
 Ball: Brass CW617N-UNIEN12165 chrome-plated  
 Sleeve, Stem, Nut: Brass CW614N-UNIEN12164  
 Seals: pure PTFE  
 O-Rings: Nbr+Fkm  
 Seeger: bronze  
 Seeger for the nut: Stainless steel  
 Handle: Aluminium EN-AB46100  
 Screw: Zincplated steel



**Working temperature:** -20° +60°C

**Max pressure:** 5 bar (Mop5)

**Nut's thread:** UNI ISO 228/1

**Other threads:** UNI EN 10226-1 (ex ISO7/1)

**Conforming with:** UNI EN 331

**FINAL TEST** conforming with UNI EN 12266-1 points A3 or A4

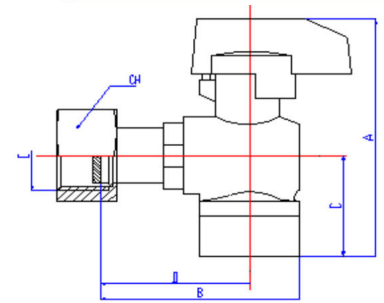

Misura Size f. - nut	A	B	C	D	E	CH	DN
1/2" x 1/2"	66,6	50	25,6	37	1/2"	24	10
1/2" x 3/4"	66,6	46	25,6	33	3/4"	30	10