

71 Series



Parker's Snap-tite 71 Series couplings are designed for working pressures up to 10,000 psi. Available in a variety of materials and with a wide range of body sizes.

Air inclusion and fluid loss are minimal with the flush face valves. Large flow chambers in the body and an exclusive valve design permit superior flow while maintaining low pressure drop.

The Series 71 has been designed to eliminate fluid loss and air inclusion. The dirt tolerant, heavy-duty construction withstands abusive treatment.



Size: 1/4" thru 1-1/4"***

Flow Charts

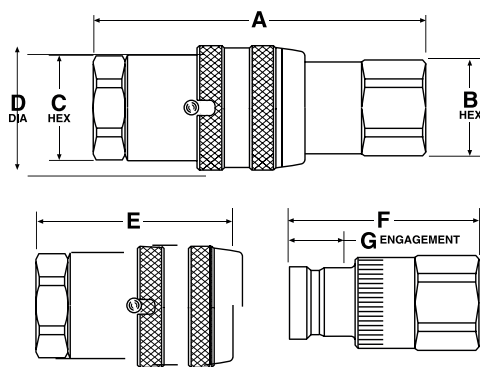

Size	A	B (Hex)*	C (Hex)*	D (Dia.)	E	F	G
1/4" (mm)	3.27 (83.06)	0.81 (20.57)	0.94 (23.88)	1.19 (30.23)	1.96 (49.78)	1.84 (46.74)	0.53 (13.46)
3/8" (mm)	4.00 (101.60)	1.00 (25.40)	1.19 (30.23)	1.56 (39.62)	2.36 (59.95)	2.32 (58.93)	0.68 (17.27)
1/2" (mm)	4.43 (112.52)	1.50 (38.10)	1.50 (38.10)	1.88 (47.75)	2.77 (70.36)	2.38 (60.45)	0.72 (18.29)
3/4" (mm)	5.13 (130.30)	1.75 (44.45)	1.75 (44.45)	2.25 (57.15)	3.05 (77.47)	2.96 (75.18)	0.88 (22.35)
1" (mm)	5.60 (142.24)	1.88 (47.75)	2.00 (50.80)	2.63 (66.80)	3.32 (84.33)	3.23 (82.04)	0.95 (24.13)
1-1/4" (mm)	6.22 (157.99)	2.00 (50.80)	2.00 (50.80)	2.63 (66.80)	3.67 (93.22)	3.50 (88.90)	0.95 (24.13)

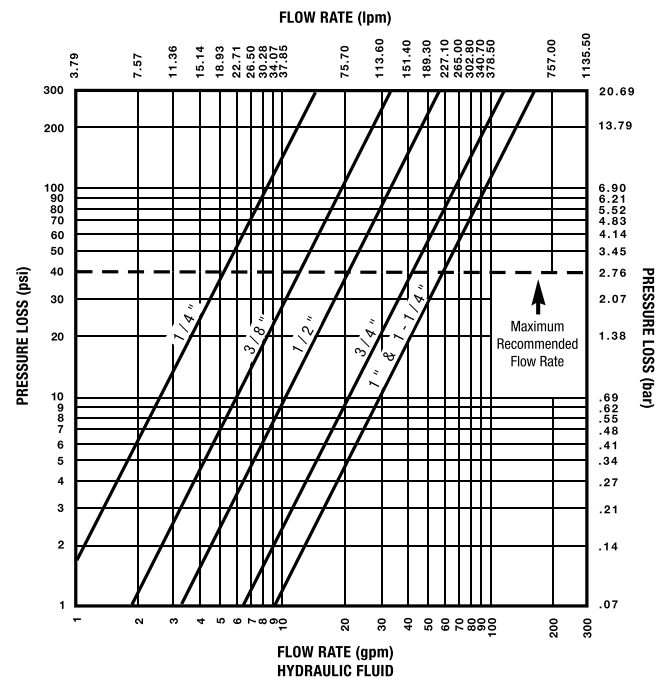



Torque Values for Connecting Under Pressure

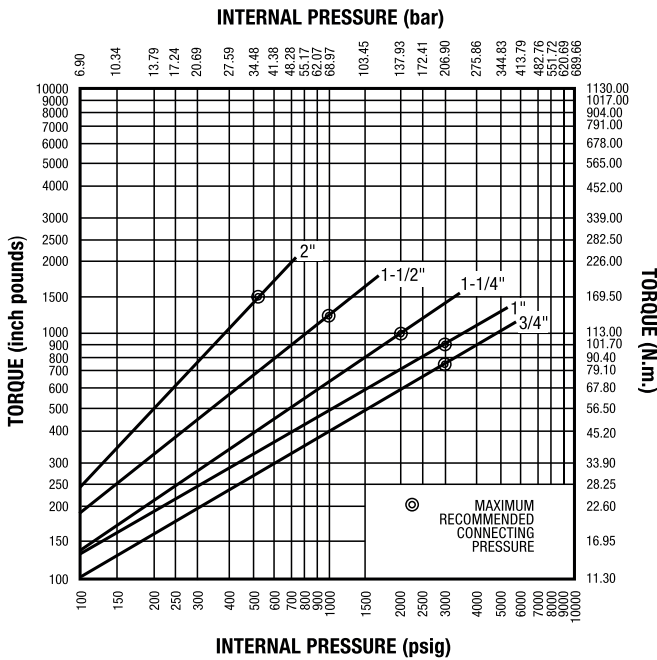

Flow Chart

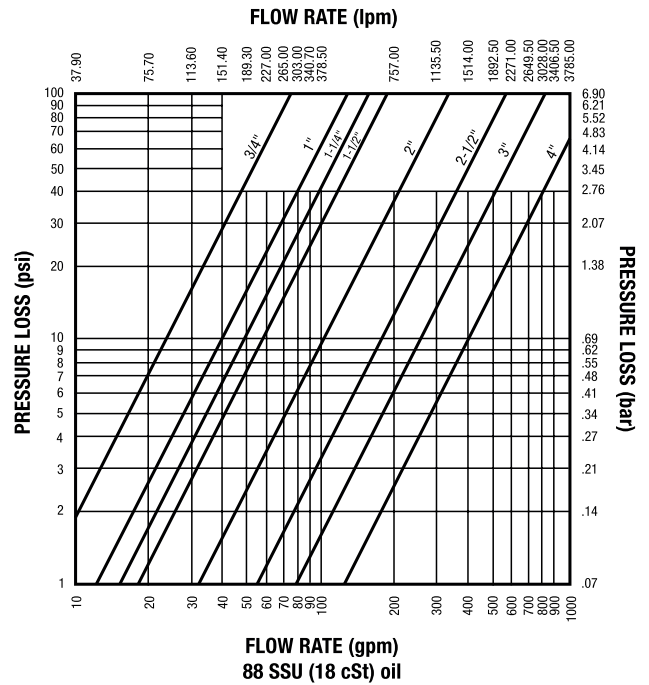

Pressure Ratings

Size	Spillage (cc)	Air Inclusion (cc)	Maximum Working Pressure Steel Only		Maximum Burst Pressure Steel Only		Maximum Working Pressure 316 Stainless (Connected Only)	
			PSI	Bar	PSI	Bar	PSI	Bar
3/4"	8	12	5,000	345	20,000	1379	3,000	207
1"	16	25	5,000	345	20,000	1379	3,000	207
1-1/4"	31	48	5,000	345	15,000	1035	3,000	207
1-1/2"	64	98	5,000	345	15,000	1035	3,000	207
2"	141	205	5,000	345	15,000	1035	3,000	207
2-1/2"	204	368	3,000	207	6,000	414	-	-
3"	320	480	3,000	207	6,000	414	-	-
4"	400	610	400	28	1,000	69	-	-

Burst pressures listed were taken at the point at which failure rendered the quick-disconnect inoperative. (Proof pressure equals 1-1/2 times the operating pressure).
 NOTE: Pressure Ratings were established under static pressure conditions.
 For impulse applications, multiply the above pressure ratings by .6 for approximate pressure ratings.
 -Contact QCD



Ordering Information

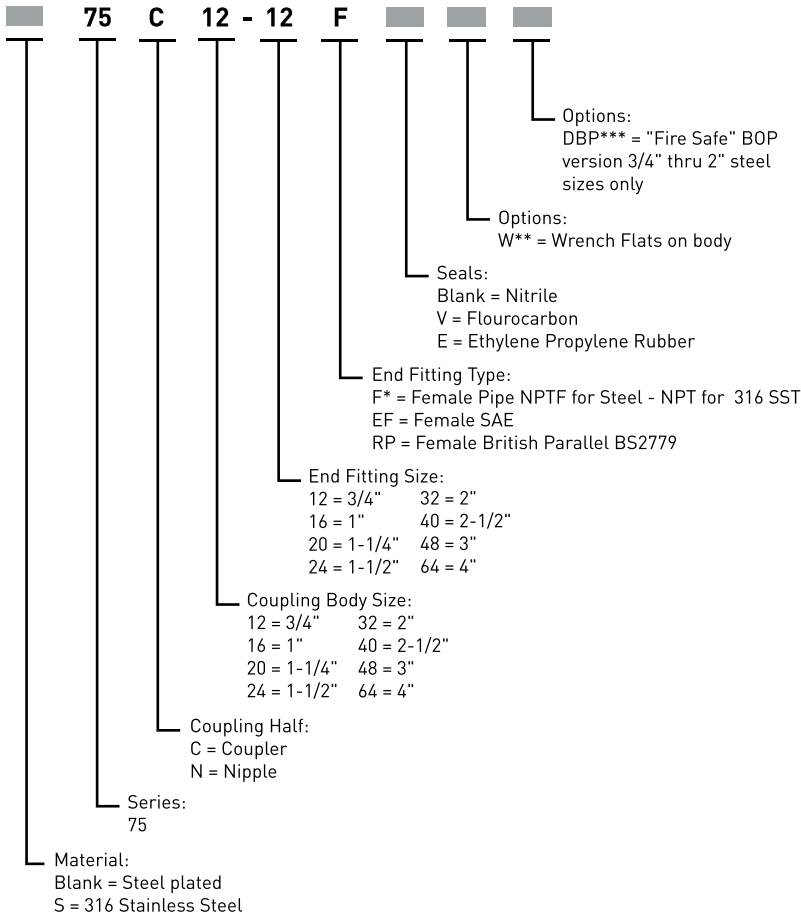

Dust Plugs and Caps

Size	Dust Plug	Dust Cap
3/4"	75MDP-12	75MDC-12
1"	75MDP-16	75MDC-16
1-1/4"	75MDP-20	75MDC-20
1-1/2"	75MDP-24	75MDC-24
2"	75MDP-32	75MDC-32
2-1/2"	75MDP-40	75MDC-40
4"	75MDP-64	75MDC-64

Repair Kits

Size	Coupler Kit	Nipple Kit
3/4"	75C12-SPK	75N12-SPK
1"	75C16-SPK	75N16-SPK
1-1/4"	75C20-SPK	75N20-SPK
1-1/2"	75C24-SPK	75N24-SPK
2"	75C32-SPK	75N32-SPK
2-1/2"	75C40-SPK	75N40-SPK
4"	75C64-SPK	75N64-SPK

Each kit contains a valve assembly, spring and guide stop.
Consult QCD for "DBP" option seal kits.

* For sizes up to 3", NPTF threads. For sizes over 3", NPT threads.
 **Not available on 2" EF coupler. Standard on 2-1/2" and larger sizes (code not needed).
 ***DBP available in 3/4" through 2" sizes. Steel material only.
 †Seal material code not applicable with DBP option-leave blank.

Note: Not all configurations are standard product offering.
Contact QCD for price and delivery.