

# Guide Units "H" Type

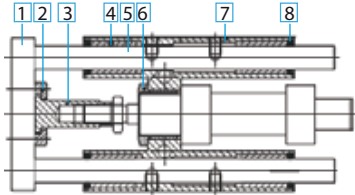

## ISO6432 Mini Cylinder Guides

### Materials Sectional View



- 1 Aluminio / Aluminium
- 2 Acero / Steel
- 3 Acero / Steel
- 4 Rodamiento bolas: Acero / Ball bearing: Steel  
Casquillo bronce: Bronce / Slide bushing: Bronze
- 5 Acero cromado / Chromed steel
- 6 Acero / Steel
- 7 Aluminio / Aluminium
- 8 NBR

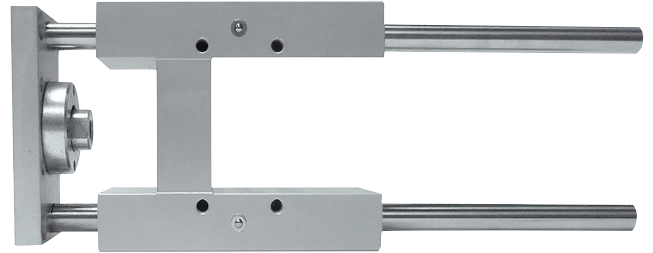

### Dimensions

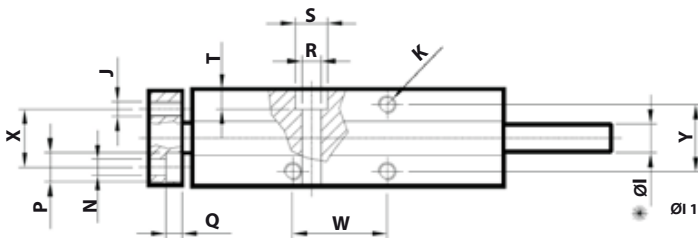
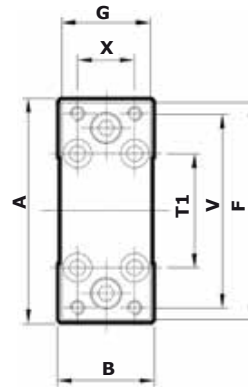
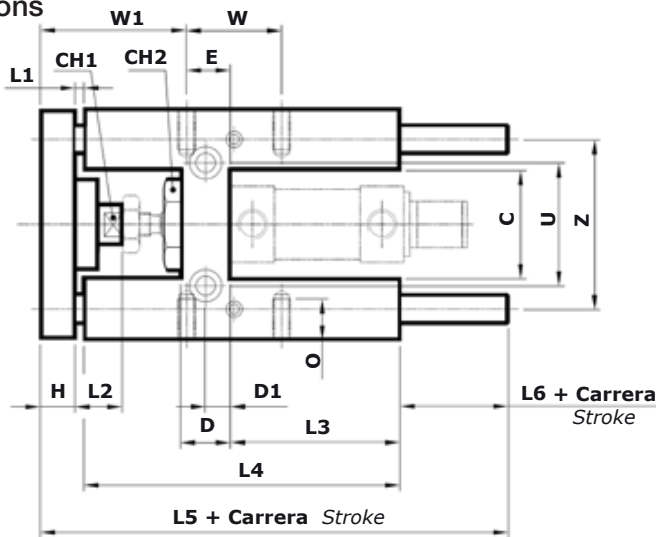

- Ø1 Casquillo Bronce / With Slide Bushing
- Ø12 Rodamiento Bolas / With Ball Bearing

#### Contera Larga Long Coupling

Ø	L1	L2	L6
20	25	40	87
25	25	40	91

#### Contera Corta Short Coupling

Ø	A	B	C	Ch1	Ch2	Ch3	D	D1	E	F	G	H	Ø1	Ø2	J	K	L1	L2	L3
16	69	30	30	8	10	24	12	6	8	66	29	10	10	8	M4	M4	25	18	46
20	79	34	37	12	13	27	17	8,5	15	78	32	12	12	10	M5	M6	3	18	58
25	79	34	37	12	17	27	17	8,5	15	78	32	12	12	10	M5	M6	3	18	58

Ø	L4	L5	L6	L7	M	N	O	P	Q	R	S	T	T1	U	V	W	W1	X	Y	Z
16	68	123,5	73	20,5	4	4,5	6	8	4,5	5,5	9	5,5	32	24	58	18	-	18	22	49,5
20	108	166	43	21	5	5,5	9	10	7,5	6,5	11	6,5	38	38	68	32,5	50	20	23	58
25	108	166	43	21	5	5,5	9	10	7,5	6,5	11	6,5	38	38	68	32,5	50	20	23	58

# Guide Units "H" Type

With slide bearings

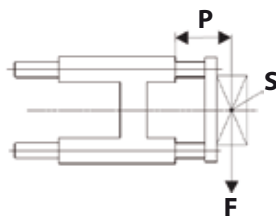

- P -> Proyección  
Projection
- S -> Centro de gravedad de la carga útil  
Centre of gravity of working load
- F -> Carga permisible  
Permissible load

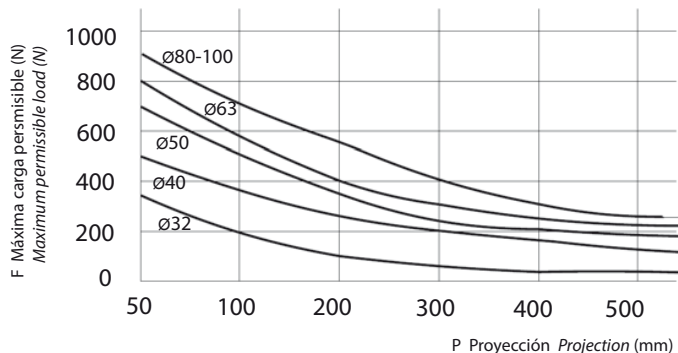
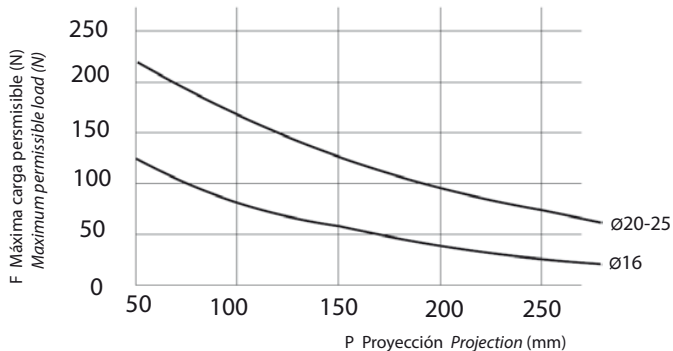

With ball bearing

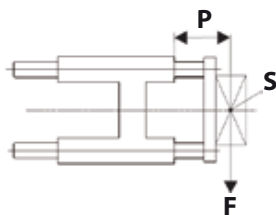

- P -> Proyección  
Projection
- S -> Centro de gravedad de la carga útil  
Centre of gravity of working load
- F -> Carga permisible  
Permissible load

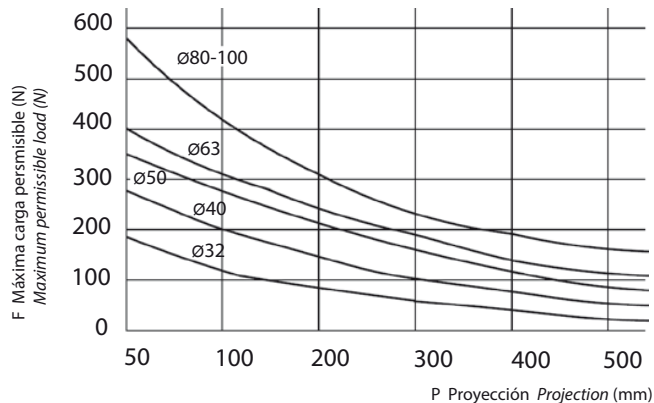
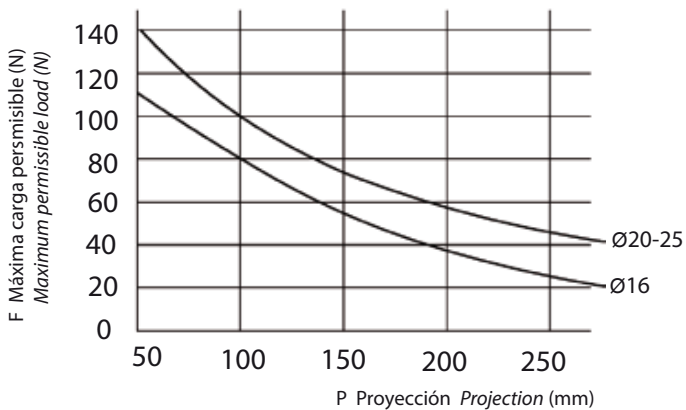

Weight

Ø	12-16	20-25	32	40	50	63	80	100
Peso en Kg. (Carrera 0) Weight in Kg (Stroke 0)	0,4	0,9	1,3	2,4	3,5	4,6	8,4	11,8
Incremento cada 100mm (Kg) Increase every 100mm (Kg)	0,12	0,18	0,18	0,32	0,5	0,5	0,77	0,77