

# Malleable Iron Pipe Fittings

CRANE

## Self Aligning Equal Union (Fig 290)

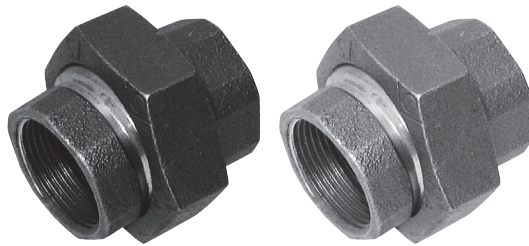
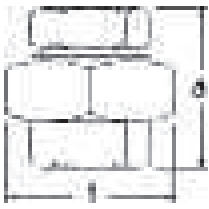

FITTING SIZE	DIMENSIONS (mm)		WEIGHT (kg) per 100 pieces
	a	f	
1/2	49	44	22.96
3/4	52	48	28.66
1	57	55	37.44
1 1/4	67	67	60.00
1 1/2	78	76	94.48
2	87	90	134.79

### The Crane SA (Self Aligning Union)

The Crane SA Union is made with double spherical seats. Pipes which are not in alignment can be securely connected at any angle up to 6° of arc from centre line of the union, thus avoiding the need for offsets. The union provides a pressure tight joint without the use of gaskets or washers.

- Self aligning (SA) Union
- Double spherical seats
- Iron to iron seating
- Taper threads to BS 21 (ISO 7-1)
- Black or Galvanised

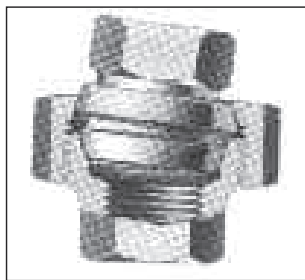

SA Union - female

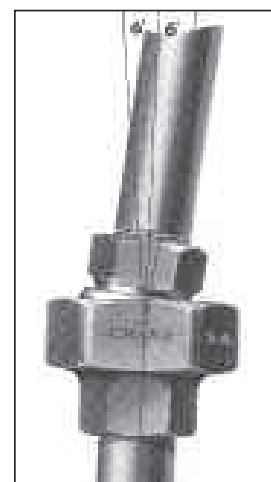

6° out of alignment and still pressure tight