

# Straight Coupling (Metric)



## Benefits:

- Leak free O-ring seal
- Safe joint every time
- Low tightening torque and clamping force rises with the internal pressure.
- Low installed cost, no welding (so inert gas purging, NDT and excessive flushing are not required), minimal tube preparation and no special assembly equipment required.
- Demountable and reusable, can be used with most tube materials.

## Features:

Body – mild steel, stainless steel or cupro-nickel.  
Compatible with most fluids and environments. Locates O-ring and tube.

O-ring – nitrile, FPM (Viton), EP or FEP encapsulated FPM. Compatible with most fluids. Highly resistant to leakage even under severe vibration, pressure pulsation and temperature cycling. Provides diametric seal between tube OD and body cavity.

Nut – mild steel, stainless steel or cupro-nickel.  
Compatible with most environments. Closes split collet and retains sealing mechanism.

Back-up washer – mild steel, stainless steel, or cupro-nickel. Provides additional support for the tube and locates the O-ring.

Split collet – mild steel, stainless steel or cupro-nickel.  
Clamping force rises with pressure. Large clamping area ensures minimal deformation of the tube. Retains tube in position.

- 3:1 safety factor
- Derate by 50% for high pressure gas systems
- Pressure ratings based on the tube OD tolerance to BS3602 and DIN2391C

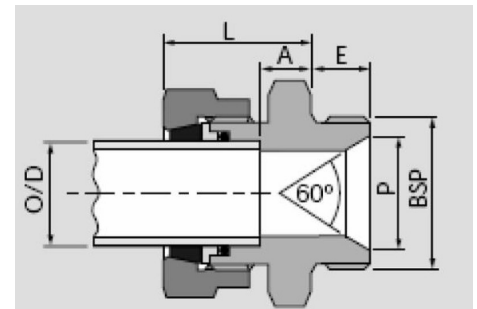

 **Working Temperature:**  
Nitrile: -40°C to +100°C  
Viton: -20°C to +150°C

 **Maximum Working Pressure:**  
6mm to 22mm: 680 bar  
25mm to 50mm: 500 bar

## All fittings also available in the following materials upon request:

- Stainless steel
- Cupro-nickel

## Seals available on request:

- EP (ethylene propylene)
- FEP encapsulated FPM

All fittings supplied with Nitrile seals as standard.

\*Derate maximum working pressure by 50% for high pressure gas systems.

Primary Item No	O/D	Thread	Part No	A mm	E mm	L mm	P mm	Nut A/F mm	Body A/F mm	*Max WP Bar
5011872	6	1/8"	KRAM6-2MSCR	10	10	26	8	16	14	680
5011885	6	1/4"	KRAM6-4MSCR	11	11	26	11	16	19	680
5011895	6	3/8"	KRAM6-6MSCR	13	13	28	14	16	22	680
5011930	8	1/8"	KRAM8-2MSCR	11	10	26	8	17	17	680
5011942	8	1/4"	KRAM8-4MSCR	11	11	26	11	17	19	680
5011950	8	3/8"	KRAM8-6MSCR	13	13	28	14	17	22	680
5011430	10	1/4"	KRAM10-4MSCR	10	11	32	11	27	27	680
5011444	10	3/8"	KRAM10-6MSCR	10	13	32	14	27	27	680
5011449	10	1/2"	KRAM10-8MSCR	10	16	32	18	27	27	680
5011513	12	3/8"	KRAM12-6MSCR	10	13	32	14	27	27	680
5011520	12	1/2"	KRAM12-8MSCR	10	16	32	18	27	27	680
5011497	12	3/4"	KRAM12-12MSCR	11	19	33	23	27	33	680
5011583	16	3/8"	KRAM16-6MSCR	11	13	34	14	32	27	680
5011596	16	1/2"	KRAM16-8MSCR	11	16	34	18	32	27	680
5011573	16	3/4"	KRAM16-12MSCR	13	19	36	23	32	33	680
5011661	20	1/2"	KRAM20-8MSCR	11	16	41	18	41	36	680
5011649	20	3/4"	KRAM20-12MSCR	11	19	41	23	41	36	680
5011656	20	1"	KRAM20-16MSCR	13	21	44	29	41	41	500
5011692	22	3/4"	KRAM22-12MSCR	13	19	44	23	41	41	680
5011710	25	3/4"	KRAM25-12MSCR	15	19	46	23	46	41	500
5011719	25	1"	KRAM25-16MSCR	15	21	46	29	46	41	500
5011724	25	1-1/4"	KRAM25-20MSCR	18	21	49	37	46	50	500
5011767	30	1"	KRAM30-16MSCR	19	21	53	29	50	46	500
5011775	30	1-1/4"	KRAM30-20MSCR	19	21	53	37	50	50	500
5011807	38	1"	KRAM38-16MSCR	24	21	62	29	60	55	500
5011814	38	1-1/4"	KRAM38-20MSCR	24	21	62	37	60	55	500
5011822	38	1-1/2"	KRAM38-24MSCR	24	25	62	43	60	60	500
5011847	50	1-1/4"	KRAM50-20MSCR	30	21	80	37	80	80	500
5011850	50	1-1/2"	KRAM50-24MSCR	30	25	81	43	80	80	500
5011855	50	2"	KRAM50-32MSCR	30	30	81	55	80	80	500