

High Pressure Hydraulic Adaptors



Male Elbow

Features:

- High working pressure
- Mild steel - high grade material
- Sealing face and threads machined to high tolerance
- High level corrosion resistance plating (CR3 compliant)
- Bonded seal centring cone
- Available in stainless steel 316 or cupro nickel

Benefits:

- Compact full flow
- Solid piece elbow
- Highly resistant to leakage even under sever vibration, pressure pulsation and temperature

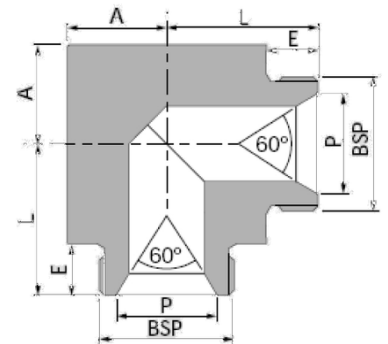
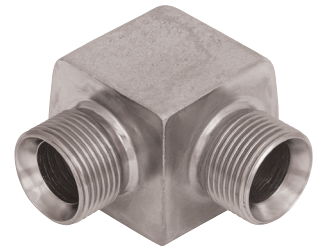

Stud BSP	Part No	L mm	E mm	A mm	P mm	Body A/F mm	Max WP Bar
1/4	KREME4*	27	11	10	11	22	680
3/8	KREME6*	29	13	13	14	27	680
1/2	KREME8	33	16	16	18	32	680
3/4	KREME12	41	19	18	23	41	680
1	KREME16*	45	21	23	29	48	500
1.1/4	KREME20	52	21	27	37	54	500
1.1/2	KREME24	60	25	30	43	60	500